



Cleaning a Pipette

Keep Your Pipette Contaminant-Free

Basic Exterior Cleaning

- Wipe exterior using a non-abrasive cloth moistened with fresh 10% bleach solution, or 60% isopropyl alcohol, or detergent solution.
- Lightly scrub any caked-on grit with a toothbrush.
- Use any detergent designed to clean labware. If sold as concentrate, dilute to manufacturer's recommended strength.
- Use care around the volume display window – excess liquid can fog or stain the screen, requiring service to replace.
- With water or distilled water, wet a non-abrasive cloth and wipe off the pipette.



Full Decontamination Single-channel pipettes only

Decontaminating your pipettes helps ensure reliable results but, done improperly, can adversely affect their performance. Take extra care when following the steps below.

Parts to Clean

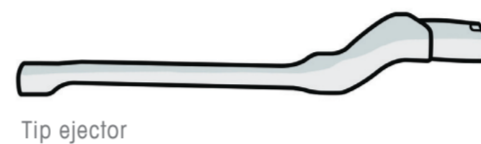

Set Aside

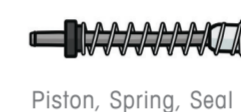

Piston disassembly and cleaning aren't recommended. Reassembling the parts incorrectly or using the wrong lubricant can negatively affect pipette performance.

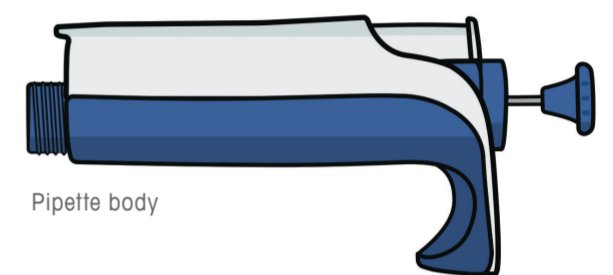

Sample	Cleanser	Action
DNA, RNA	Fresh 10% bleach solution or DNA/RNA cleanser	Immerse for 10 minutes. Rinse with distilled water. Wipe with isopropyl alcohol and allow to air dry.
Proteins	Fresh 10% bleach solution or detergent. Not alcohol	Immerse for 10 minutes. Rinse with distilled water and allow to air dry.
RNase	RNase decontaminant solution (RNaseAway®, RNaseZap®) or 95% EtOH followed by 3% H ₂ O ₂	Immerse in RNase decontaminant solution for one minute, then rinse with distilled water and air dry. Alternatively, immerse briefly in 95% ethanol, rinse, then immerse in 3% hydrogen peroxide for 10 minutes. Rinse, and air dry.
Aqueous solution	Detergent solution or 70% ethanol	Immerse for 5 minutes. Rinse with distilled water, then wipe with isopropyl alcohol and allow to air dry.
Organic solvent	Detergent solution	Immerse for 5 minutes. Rinse with distilled water and allow to air dry.
Radioactive sample	High-strength radioactivity decontaminant (COUNT-OFF™ surface cleaner, Decon 90™ cleaning agent)	Immerse for 5 minutes. Rinse 3x with distilled water. Measure with Geiger counter for radioactivity. Properly dispose of gloves, liquids and all cleaning materials according to your organization's radioactive safety procedures.

Notes: Rainin shafts and tip ejectors are fully autoclavable. On XLS+ models, the piston assembly is too. When using cleansers – particularly bleach – be sure to rinse thoroughly.

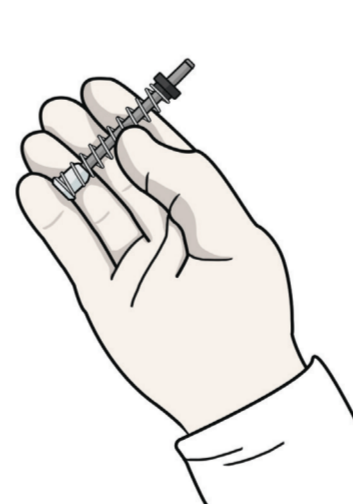

Inspect piston
Look for nicks, corrosion

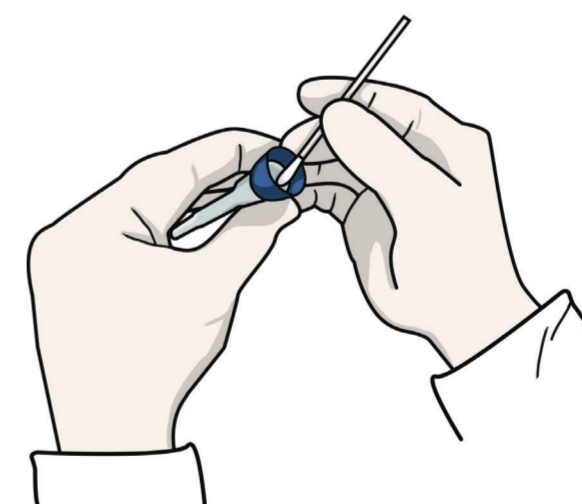

Use long-stemmed foam swab
Moisten with cleaning agent

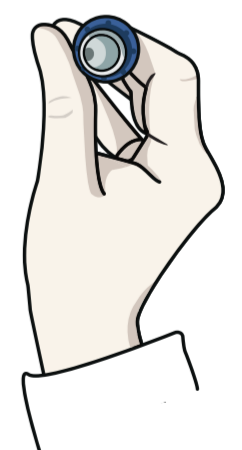

Examine shaft interior
Look for obstructions

Also consider...



Filter Tips
Using filter tips to prevent liquid, particles and aerosols from contaminating pipette



10 µL ShaftGuard™ Tips
Using ShaftGuard tips, which protect pipette shaft from radioactive and other hazardous samples



Bleach
Cleaning work area regularly with fresh 10% bleach solution

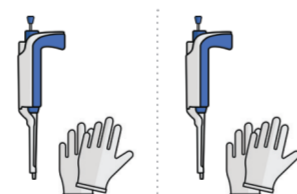

Workflow
Designating separate work areas for specific applications and workflow steps